

| POS-NR. | Bez | MENGE |
|---------|-----|-------|
| 1 | 1 | 1 |
| 2 | 3 | 1 |
| 3 | 4 | 1 |
| 4 | 5 | 1 |
| 5 | 23 | 1 |
| 6 | 24 | 1 |
| 7 | 38 | 1 |
| 8 | 39 | 1 |
| 9 | 40 | 1 |
| 10 | 41 | 1 |
| 11 | 42 | 1 |
| 12 | 43 | 1 |
| 13 | 49 | 1 |
| 14 | 50 | 1 |
| 15 | 51 | 1 |
| 16 | 52 | 1 |
| 17 | 53 | 1 |
| 18 | 54 | 1 |
| 19 | 56 | 1 |
| 20 | 2 | 1 |
| 21 | 6_1 | 1 |
| 22 | 7 | 1 |
| 23 | 25 | 1 |
| 24 | 26 | 1 |

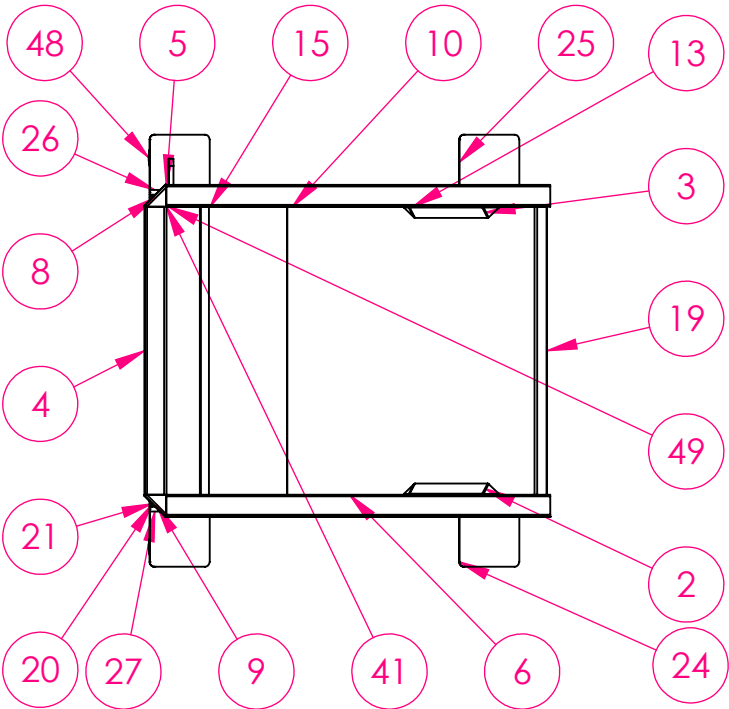

| POS-NR. | Bez | MENGE |
|---------|-----|-------|
| 25 | 27 | 1 |
| 26 | 28 | 1 |
| 27 | 29 | 1 |
| 28 | 30 | 1 |
| 29 | 31 | 1 |
| 30 | 32 | 1 |
| 31 | 33 | 1 |
| 32 | 34 | 1 |
| 33 | 35 | 1 |
| 34 | 36 | 1 |
| 35 | 37 | 1 |
| 36 | 44 | 1 |
| 37 | 45 | 1 |
| 38 | 46 | 1 |
| 39 | 47 | 1 |
| 40 | 48 | 1 |
| 41 | 55 | 1 |
| 42 | 9 | 2 |
| 43 | 10 | 2 |
| 44 | 8 | 2 |
| 45 | 14 | 2 |
| 46 | 15 | 2 |
| 47 | 16 | 2 |
| 48 | 17 | 2 |
| 49 | 22 | 1 |

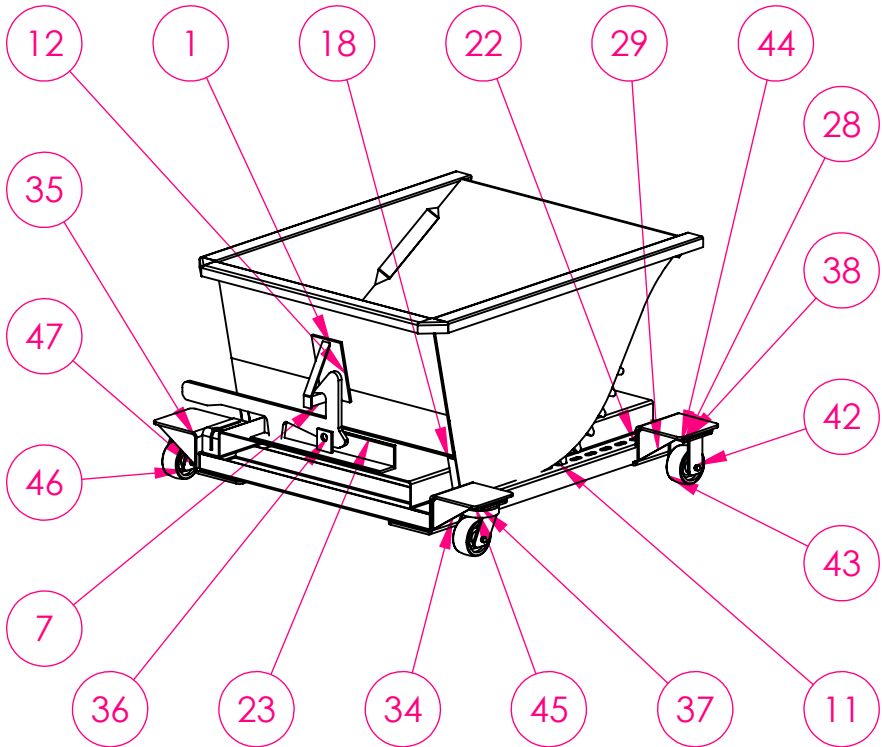
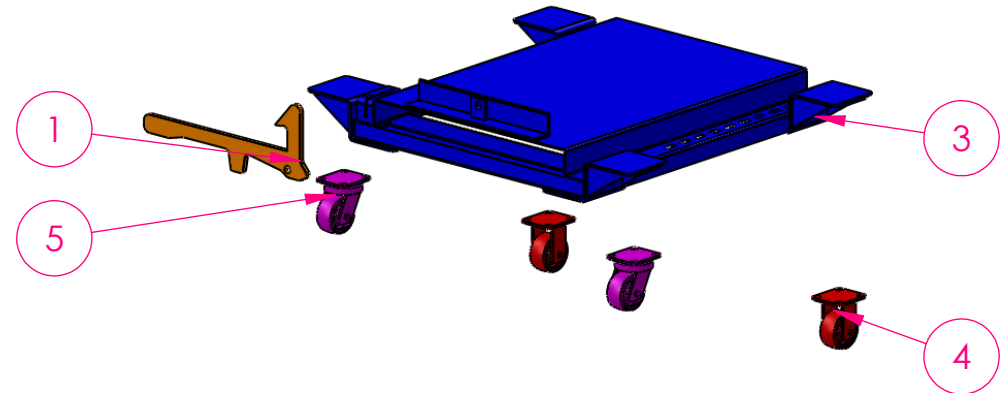
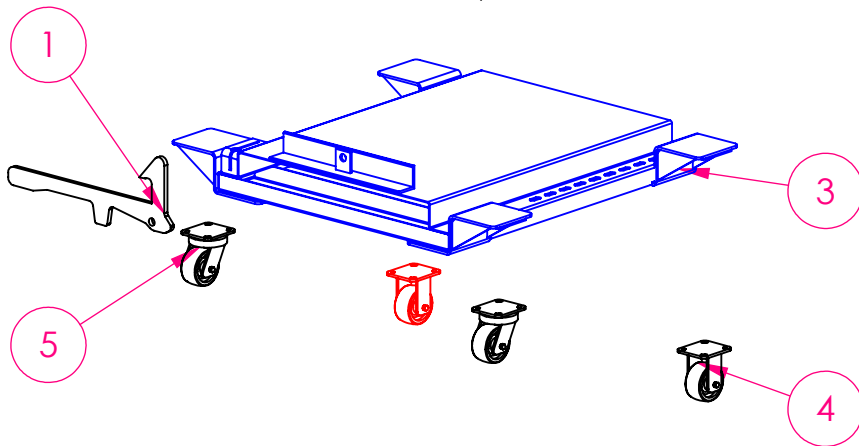
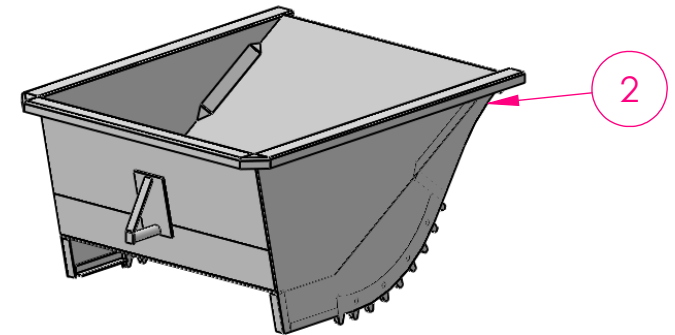
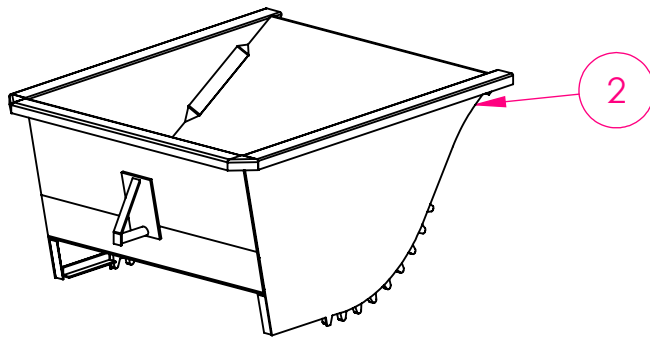
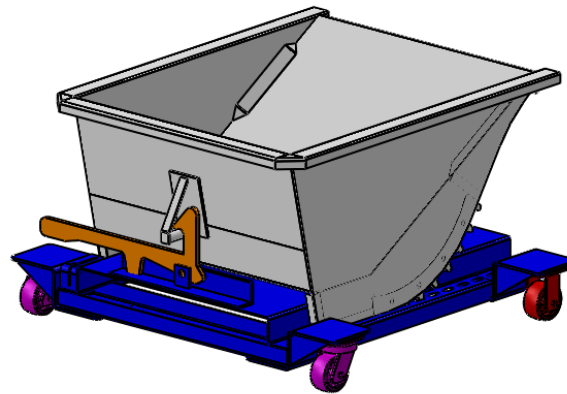

Typische Schweißbaugruppe:

Produktionsdaten: 49 Teile (siehe Blatt 1)
noch ohne Schrauben + Bolzen

Ersatzteildaten: 5 Teile (siehe Blatt 2)

=> Ziel: mit "nur" 5 Klicks aus den Produktionsdaten
zur Ersatzteil-Zg. + einfachere Explo (durch Teile-Reduktion)

| POS-NR. | BENENNUNG | MENGE |
|---------|------------------------|-------|
| 1 | ET~22 | 1 |
| 2 | ET~tiltable~dumpster | 1 |
| 3 | ET~wagon | 1 |
| 4 | ET~wheel_non_steerable | 2 |
| 5 | ET~wheel_steerable | 2 |

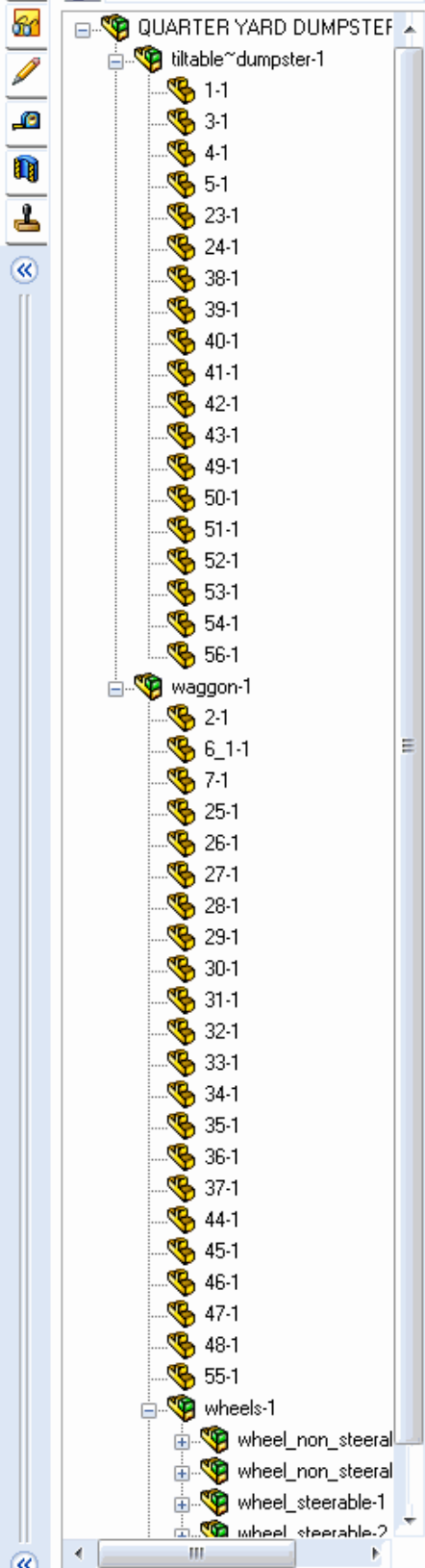
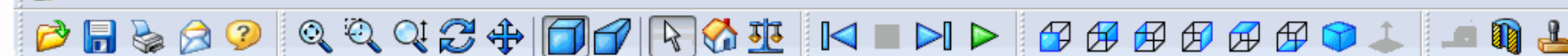
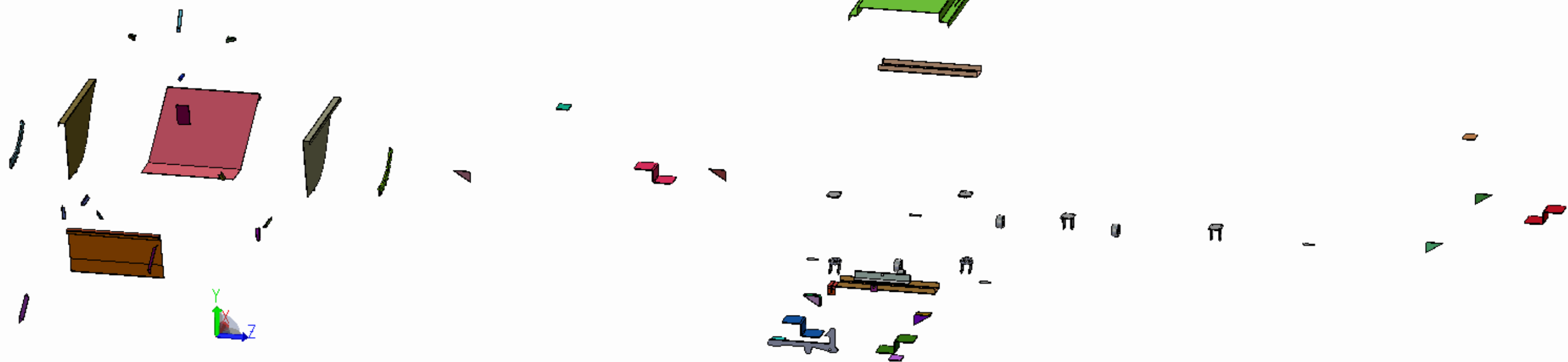

Text in Filterliste eingeben

**Auto-Explode using *Strg+E*-hotkey :**

Text in Filterliste eingeben

